



SCHOOL DISTRICT OF
REEDSBURG



SCHOOL BOARD WORKSHOP
FOR LONG-TERM FACILITIES PLANNING

December 14, 2022





VISION

The School District of Reedsburg will provide a world-class educational experience to all students at all levels, inspiring creativity, innovation, and a desire to achieve greatness.



LONG-TERM FACILITIES PLANNING

The School District of Reedsburg is focused on creating innovative facilities with modern learning environments that will support rigorous academic programs and career pathways for ALL students. The aim of long-term facilities planning is to map out, over time, how existing facilities can best be adapted to support future educational programming, which aging buildings should be considered for replacement, and when deferred maintenance needs should be addressed.

Success Criteria for Tonight's Workshop

1. Understand updated building capacity and utilization information, as well as how the various “funnel factors” impact long-term facilities planning.
2. Become familiar with long-term planning tools (spreadsheets, building graphics) and how they will help us explore different “what if?” options
3. Identify “destination/ big ideas” for future exploration and analysis
4. Leave with common messaging and understanding about the next steps in the work, in particular from January - June 2023.



Strategic Focus Areas

1. Rigorous Academic Programs and Career Pathways for All Students
2. Continuous Improvement of Student Growth and Achievement
3. Innovative Facilities with Modern Learning Environments
4. Personnel Excellence: Attracting, Developing, and Retaining High Quality Staff
5. Responsible Fiscal Management: Funding our Priorities and Demonstrating a Return on the Public's Investment in our Schools.
6. Branding the School District of Reedsburg: Communicating and Marketing that Brand.



2022-2023 Tactical Plans

Innovative Facilities with Modern Learning Environments

- Develop a long-term facilities plan for Board adoption no later than the June 2023 Board meeting.
- Finalize the development of a 10-Year Capital Projects Plan for Board approval.

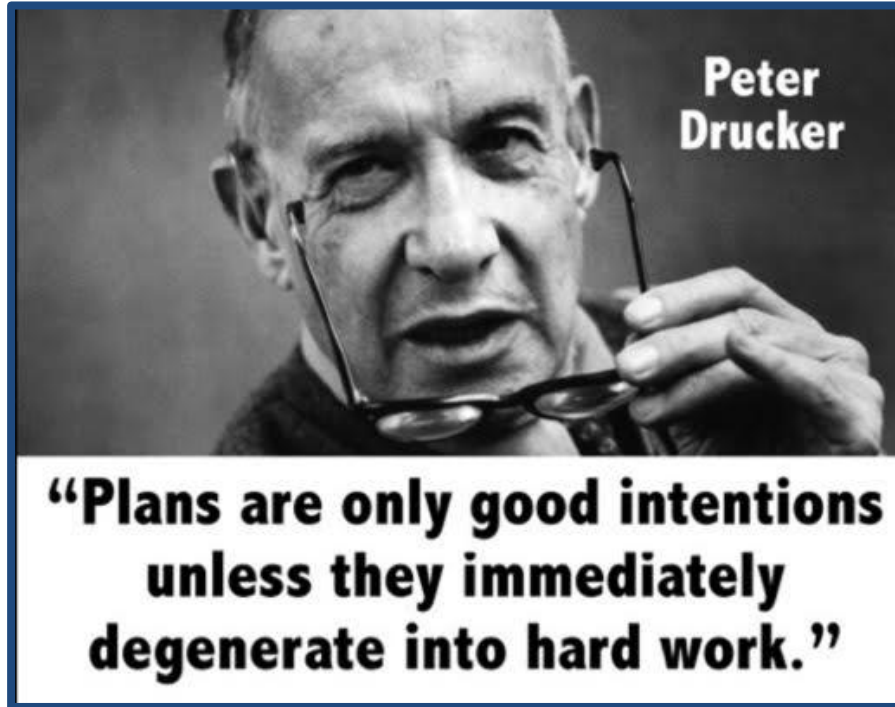

COMMUNITY INVOLVEMENT

LONG-TERM FACILITIES PLANNING

COMMUNITY INVOLVEMENT

PRIORITIES

COMMUNITY INVOLVEMENT

OPTIONS

COMMUNITY INVOLVEMENT

PROJECT



School District of Reedsburg
Long-Term Facilities Planning 2022-23

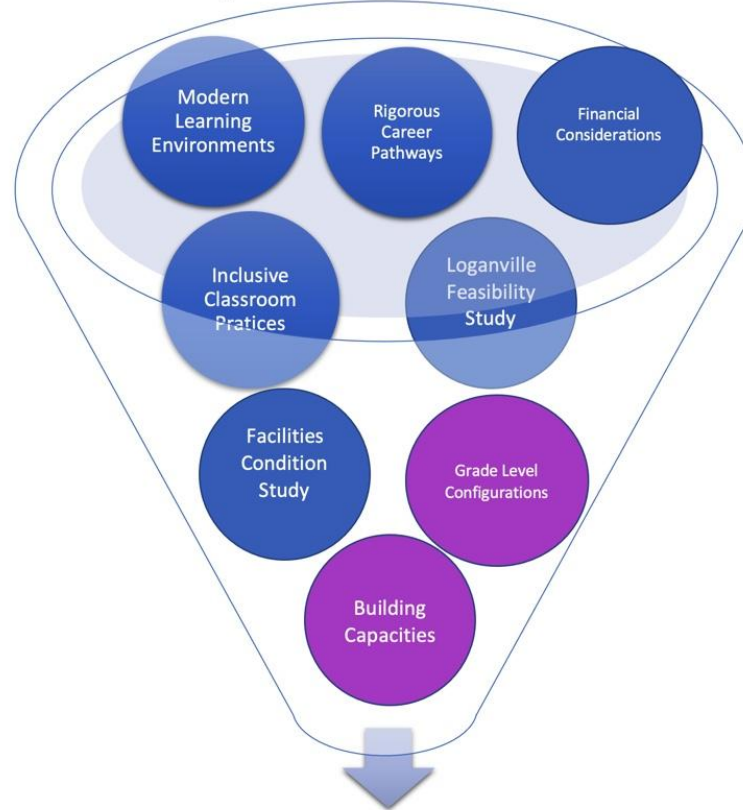

Long-Term Facilities Plan

June, 2023



Updated Building Capacities

Building Capacity is Based on:

- Number of Students per Room
- Number of Rooms Available
- How a room is used
- Utilization Factor (elementary, middle, high)

If any of the items above change, the resulting capacity will change...increase or decrease

DISTRICT DESIRED TARGET CLASS SIZE	
Grade Level	2022 District Desired Target Class Size
4K - K	18 students
Grades 1 - 2	20 students
Grades 3 - 5	23 students
Grades 6 - 12	25 students
Lab Instruction	20 students



2021 Capacity

BUILDING CAPACITY		
BUILDING	CURRENT ENROLLMENT SEPTEMBER 2021 ^e	FUNCTIONAL CAPACITY ^c BY DESIRED TARGET CLASS SIZE ^b
Ironton-Lavalle Elementary	23 students	90 students
Loganville Elementary	30 students	90 students
Pineview Elementary	308 students	293 students
Westside Elementary	188 students	189 students
Prairie Ridge Intermediate	508 students	476 students
Webb Middle School	574 students	612 students
Reedsburg Area High School	890 students	992 students

2022 Capacity Update

FUNCTIONAL CAPACITY ^c BY DESIRED TARGET CLASS SIZE ^b
NA
NA
346 students
207 students
559 students
589 students
1112 students



Pineview Elementary School

Building Capacity:

- (3) rooms added to capacity



Westside Elementary School

Building Capacity:

- (1) room added to capacity

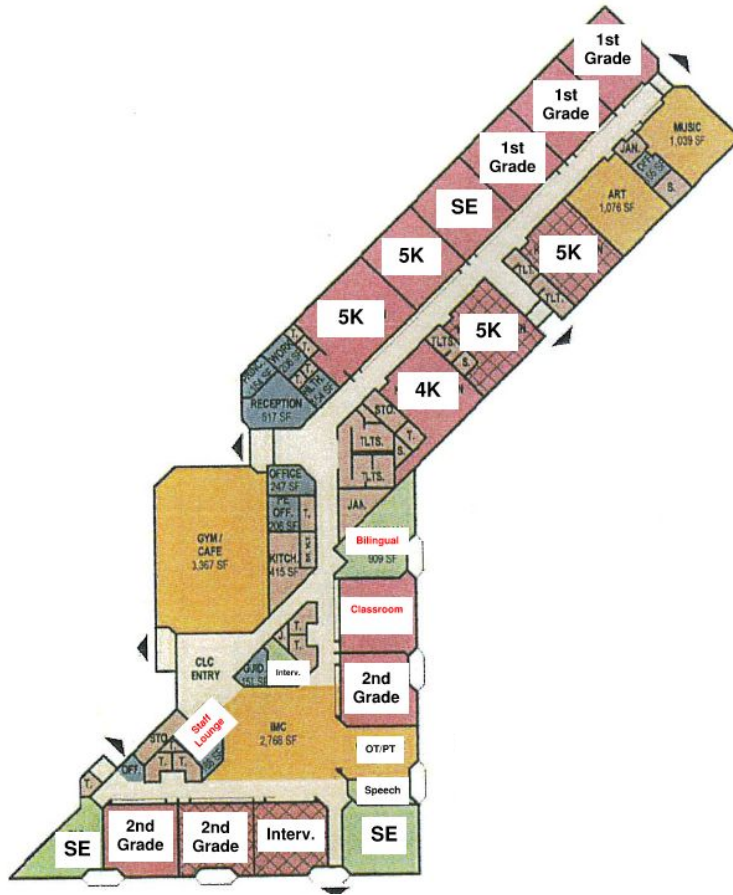

Prairie Ridge Intermediate School

Building Capacity:

- (4) rooms added to capacity

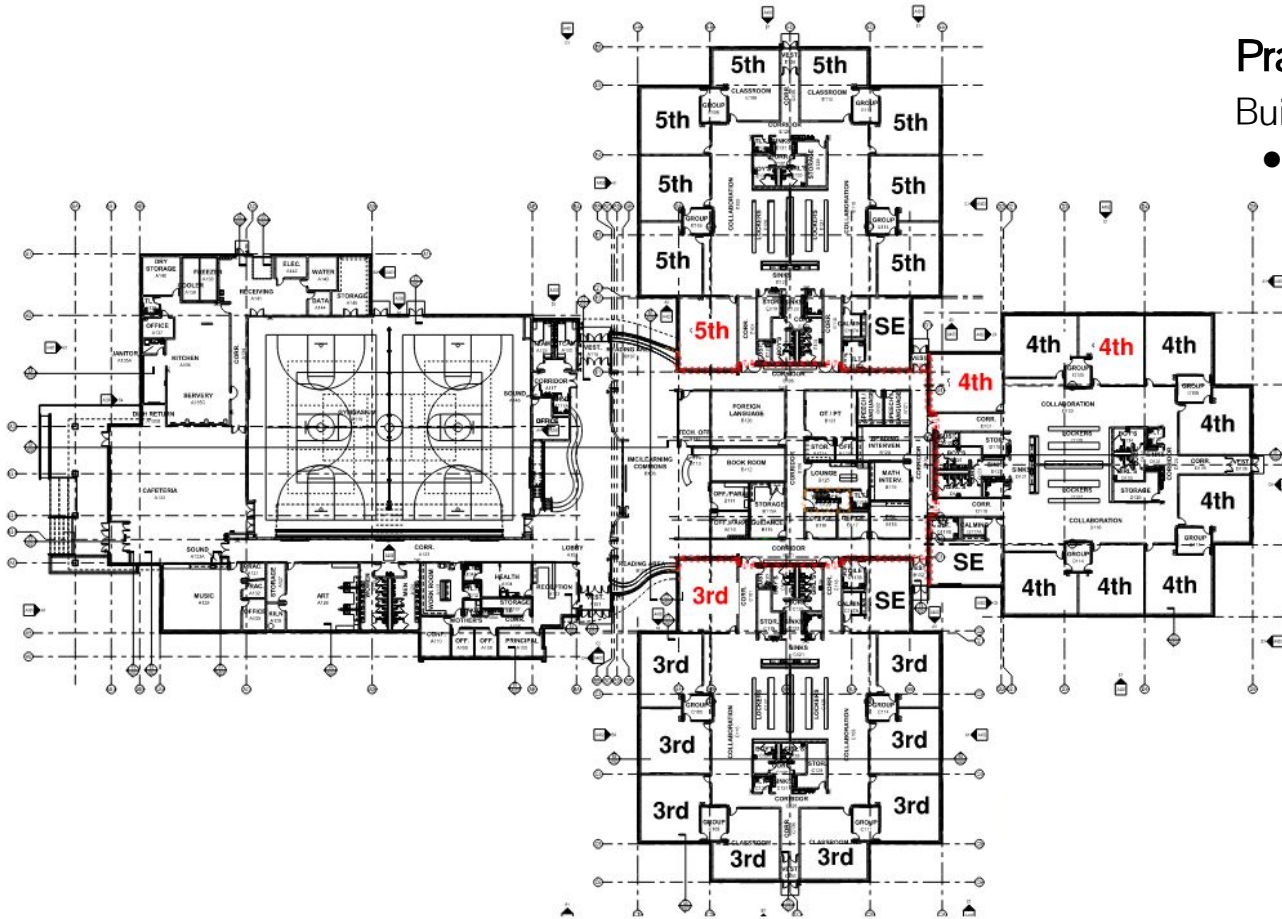

Webb Middle School

Building Capacity:

- Utilization decreased to 75%

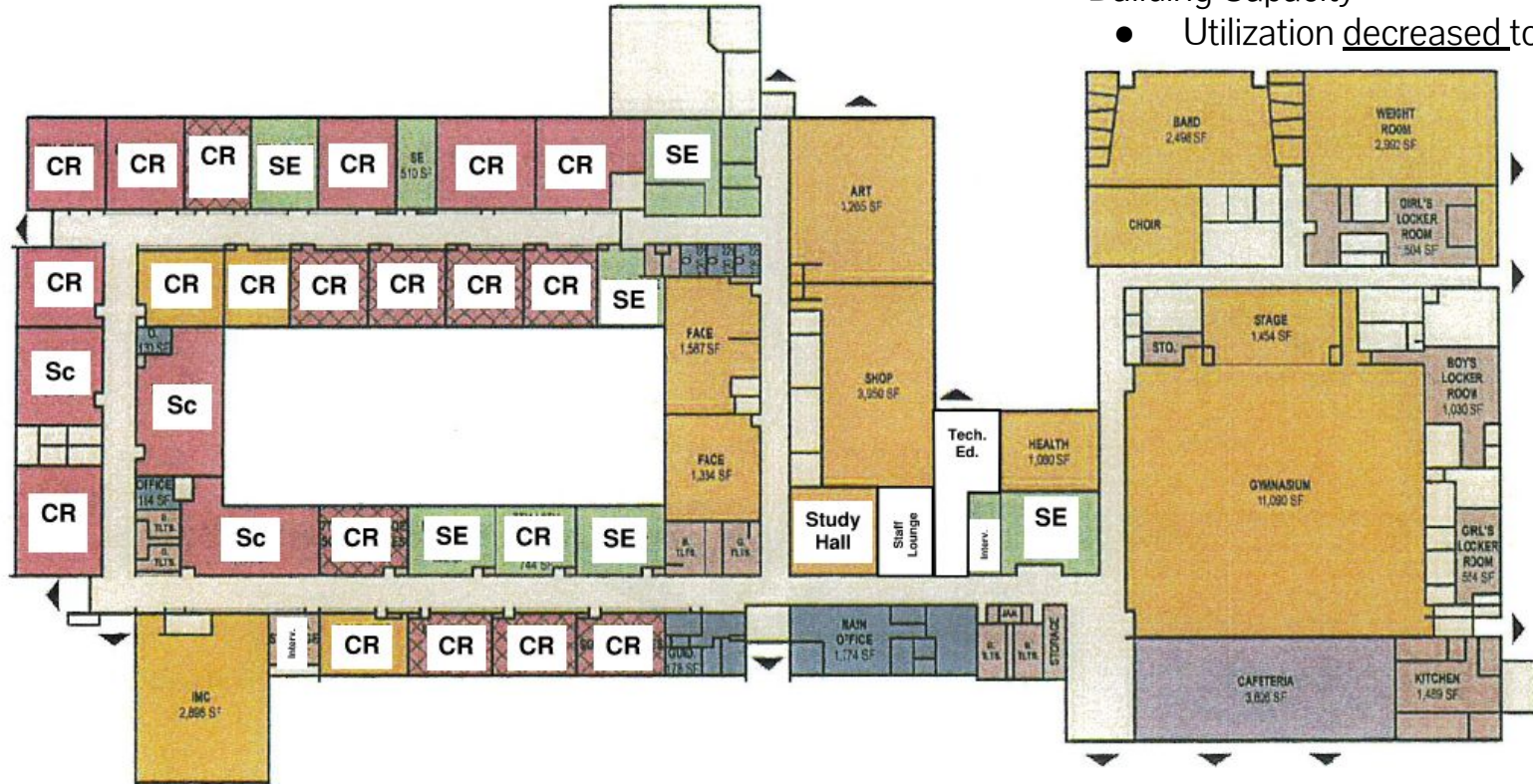

Reedsburg Area High School

Building Capacity:

- (6) rooms added to capacity

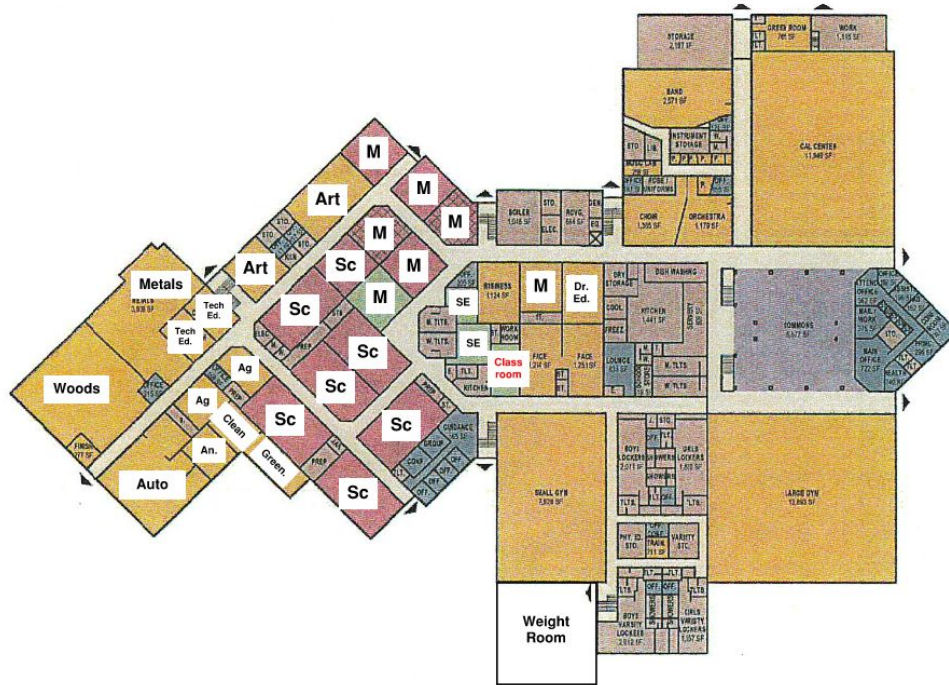

First Floor Plan

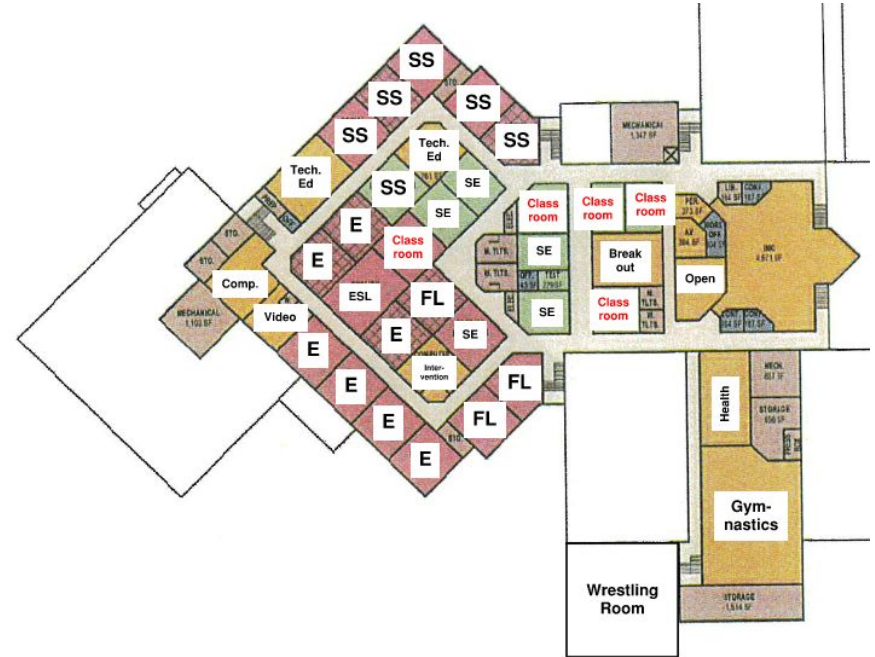

Second Floor Plan



2021 Capacity

BUILDING CAPACITY			
BUILDING	CURRENT ENROLLMENT SEPTEMBER 2021 ^a	FUNCTIONAL CAPACITY ^c BY DESIRED TARGET CLASS SIZE ^b	FUNCTIONAL CAPACITY ^c BY DESIRED TARGET CLASS SIZE ^b
Ironton-Lavalle Elementary	23 students	90 students	NA
Loganville Elementary	30 students	90 students	NA
Pineview Elementary	308 students	293 students	346 students
Westside Elementary	188 students	189 students	207 students
Prairie Ridge Intermediate	508 students	476 students	559 students
Webb Middle School	574 students	612 students	589 students
Reedsburg Area High School	890 students	992 students	1112 students

2022 Capacity Update



QUESTIONS?



LONG-TERM FACILITY PLANNING:

Think of it as a road trip...



What is your Destination?



- 4K Community Sites
- Loganville
- Pineview
- Westside
- Prairie Ridge
- Webb
- RAHS
- Hartje Center
- Central Office
- Other District Facilities



What are you Packing?

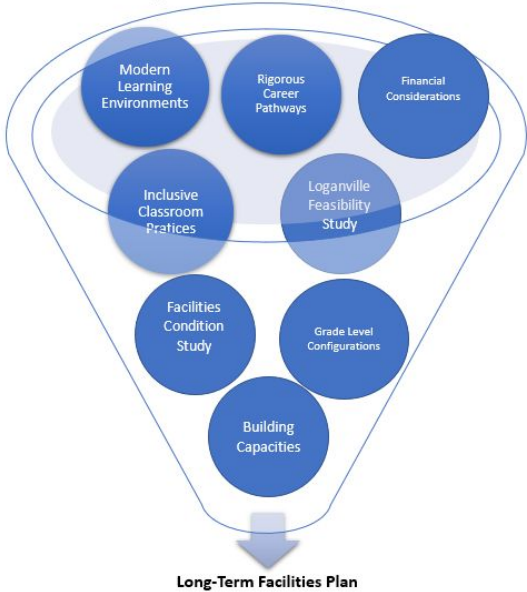

What is your Route?



- How does enrollment factor into your priorities?
- What is your first phase?
- What is your second phase?
- How will projects be funded?



How do you Adapt to Challenges Along the Way?



LONG-TERM FACILITY PLANNING:

What does the district look like in 30 years?...



LONG-TERM FACILITY PLANNING:

CURRENT BUILDINGS AND GRADE STRUCTURE



LONG-TERM FACILITY PLANNING

ILLUSTRATIVE
PURPOSES
ONLY

EXAMPLE OF LONG-TERM “DESTINATION”

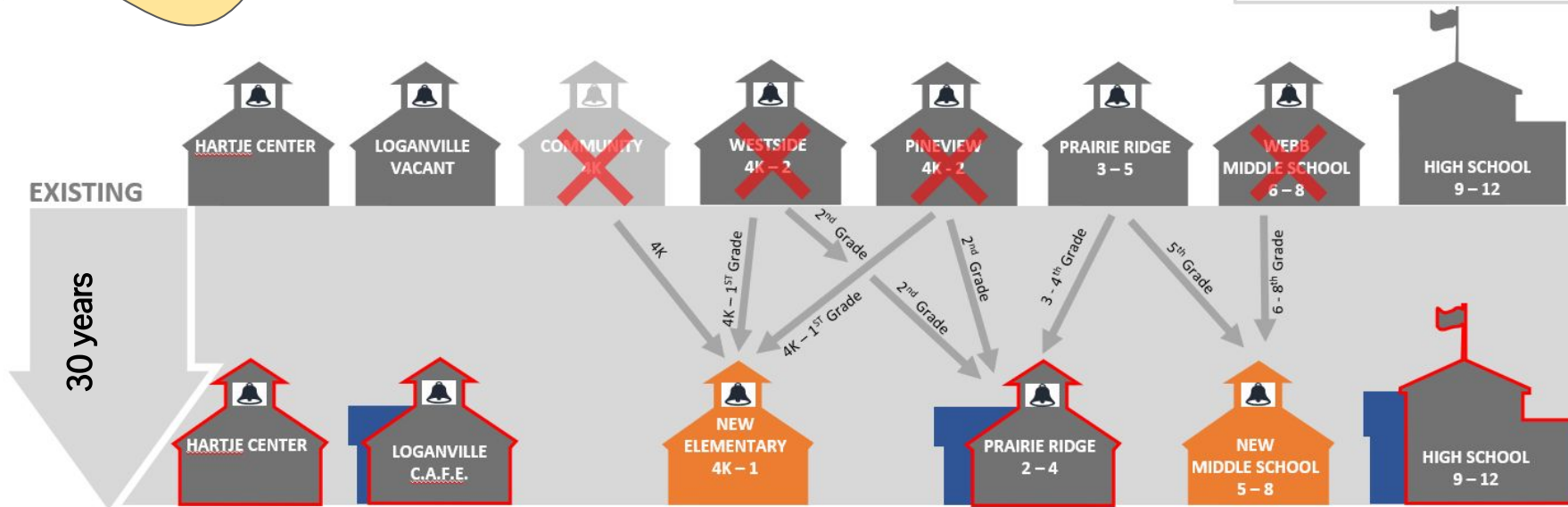

LONG-TERM

- Improve amenities for outdoor education center
- Update facility and provide possible additions for new use
- Construct new elementary school at Pineview site
- Building will need an addition in the future to serve predicted enrollment
- Construct new middle school on district owned property
- Would likely require addition for career pathway improvements



QUESTIONS?



LONG-TERM FACILITY PLANNING:

Tools for Exploring “*What If...?*”



LONG-TERM FACILITY PLANNING TOOLS:

GRAPHICS



ANALYSIS (SPREADSHEETS)

updated 2022.1208

SD of Reedsburg : Long-Term Facilities Planning

Significantly Under Capacity (-151 & more)
Under Capacity (-26 to -150)
Within Capacity (0/-25)
Over Capacity (+26)

Option Do Nothing

Indicates Year Data Taken Directly From MD Roffers

Grade Configuration & Current Capacity	2021-2022	2022-2023	2023-2024	2024-2025	2025-2026	2026-2027	2027-2028	2028-2029	2029-2030	2030-2031	2031-2032	2032-2033	2033-2034	2034-2035	2035-2036	
EC																
All 4K	144	155	166	166	166	167	168	169	170	170	170	170	170	170		
Half 4K	72	78	83	83	83	83	83.5	84	85	85	85	85	85	85		
Half of Half 4K	36	39	42	42	42	42	42	42	43	43	43	43	43	43	2+ sections 2036	
K-2 Enrollment	505	515	526	531	535	541	547	553	560	565	568	571	574	577	580	
Per Grade K-2	168	172	175	177	178	180	182	184	187	188	189	190	191	192	193	9+ sections 2036
3-5 Enrollment	511	514	517	527	538	542	548	554	560	566	569	573	576	579	582	
Per Grade 3-5	170	171	172	176	179	181	183	185	187	189	190	191	192	193	194	8+ sections 2036
6-8 Enrollment	583	574	566	556	547	551	556	560	565	569	575	582	589	595	602	
Per Grade 6-8	194	191	189	185	182	184	185	187	188	190	192	194	196	198	201	8 classrooms 2036
9-12 Enrollment	896	910	924	919	914	900	885	870	855	841	844	847	851	854	857	
Per Grade 9-12	224	228	231	230	229	225	221	218	214	210	211	212	213	214	214	8+ classrooms 2036
(4K-3) Enrollment/Projection	541	554	568	573	577	583	589	595	602	608	611	614	617	620	623	Enrollment/Projection
553 Capacity (90%)	553	553	553	553	553	553	553	553	553	553	553	553	553	553	553	WE PE 207 (4+ section) 346 (6 section)
(3-5) Enrollment/Projection	511	514	517	527	536	542	548	554	560	566	569	573	576	579	582	Enrollment/Projection
559 Capacity (90%)	559	559	559	559	559	559	559	559	559	559	559	559	559	559	559	(9 section)
(6-8) Enrollment/Projection	583	574	566	556	547	551	556	560	565	569	575	582	589	595	602	Enrollment/Projection
589 Capacity (75%)	589	589	589	589	589	589	589	589	589	589	589	589	589	589	589	Capacity
(9-12) Enrollment/Projection	896	910	924	919	914	900	885	870	855	841	844	847	851	854	857	Enrollment/Projection
1112 Capacity (80%)	1112	1112	1112	1112	1112	1112	1112	1112	1112	1112	1112	1112	1112	1112	1112	Capacity



CURRENT BUILDINGS AND GRADE STRUCTURE

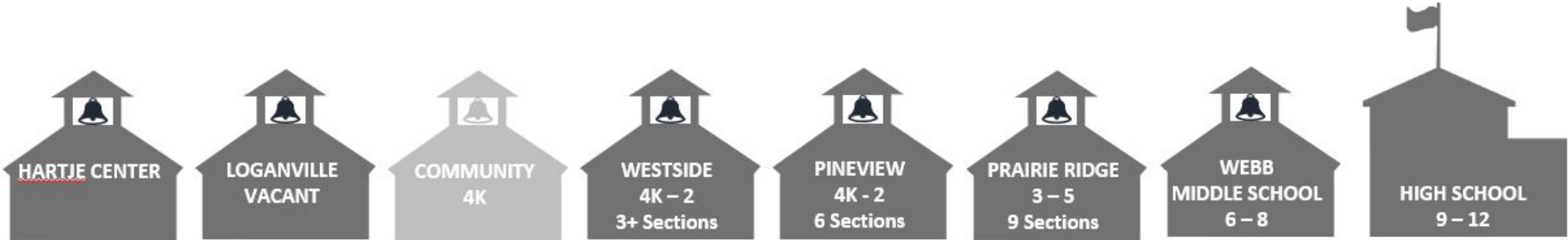

OPTION: DO NOTHING



SD of Reedsburg : Long-Term Facilities Planning

Option Do Nothing

Indicates Year Data Taken Directly From MD Roffers

Enrollment Projections Based on MD Roffers 03.21.2022 Study - Open Enrollment In

Grade Configuration & Current Capacity	2021-2022	2022-2023	2023-2024	2024-2025	2025-2026	2026-2027	2027-2028	2028-2029	2029-2030	2030-2031	2031-2032	2032-2033	2033-2034	2034-2035	2035-2036			
EC																		
All 4K	144	155	166	166	166	166	167	168	169	170	170	170	170	170	170			
Half 4K	72	78	83	83	83	83	83.5	84	85	85	85	85	85	85	85			
Half of Half 4K	36	39	42	42	42	42	42	42	42	43	43	43	43	43	43		2+ sections 2036	
K-2 Enrollment	505	515	526	531	535	541	547	553	560	565	568	571	574	577	580			
Per Grade K-2	168	172	175	177	178	180	182	184	187	188	189	190	191	192	193		9+ sections 2036	
3-5 Enrollment	511	514	517	527	536	542	548	554	560	566	569	573	576	579	582			
Per Grade 3-5	170	171	172	176	179	181	183	185	187	189	190	191	192	193	194		8+ sections 2036	
6-8 Enrollment	583	574	566	556	547	551	556	560	565	569	575	582	589	595	602			
Per Grade 6-8	194	191	189	185	182	184	185	187	188	190	192	194	196	198	201		8 classrooms 2036	
9-12 Enrollment	896	910	924	919	914	900	885	870	855	841	844	847	851	854	857			
Per Grade 9-12	224	228	231	230	229	225	221	218	214	210	211	212	213	214	214		8+ classrooms 2036	
(4K-2) Enrollment/Projection	541	554	568	573	577	583	589	595	602	608	611	614	617	620	623	Enrollment/Projection	WE	207 (3+ section)
553 Capacity (90%)	553	553	553	553	553	553	553	553	553	553	553	553	553	553	553	Capacity	PE	346 (6 section)
(3-5) Enrollment/Projection	511	514	517	527	536	542	548	554	560	566	569	573	576	579	582	Enrollment/Projection		
559 Capacity (90%)	559	559	559	559	559	559	559	559	559	559	559	559	559	559	559	Capacity		(9 section)
(6-8) Enrollment/Projection	583	574	566	556	547	551	556	560	565	569	575	582	589	595	602	Enrollment/Projection		
589 Capacity (75%)	589	589	589	589	589	589	589	589	589	589	589	589	589	589	589	Capacity		
(9-12) Enrollment/Projection	896	910	924	919	914	900	885	870	855	841	844	847	851	854	857	Enrollment/Projection		
1112 Capacity (80%)	1112	1112	1112	1112	1112	1112	1112	1112	1112	1112	1112	1112	1112	1112	1112	Capacity		



WHAT IF...?

 UPDATE SYSTEMS	 NEW BUILDING
 BUILDING ADDITION	 MOVEMENT OF STUDENTS



PROPOSED

- Construct new middle school on district owned property



WHAT IF...?

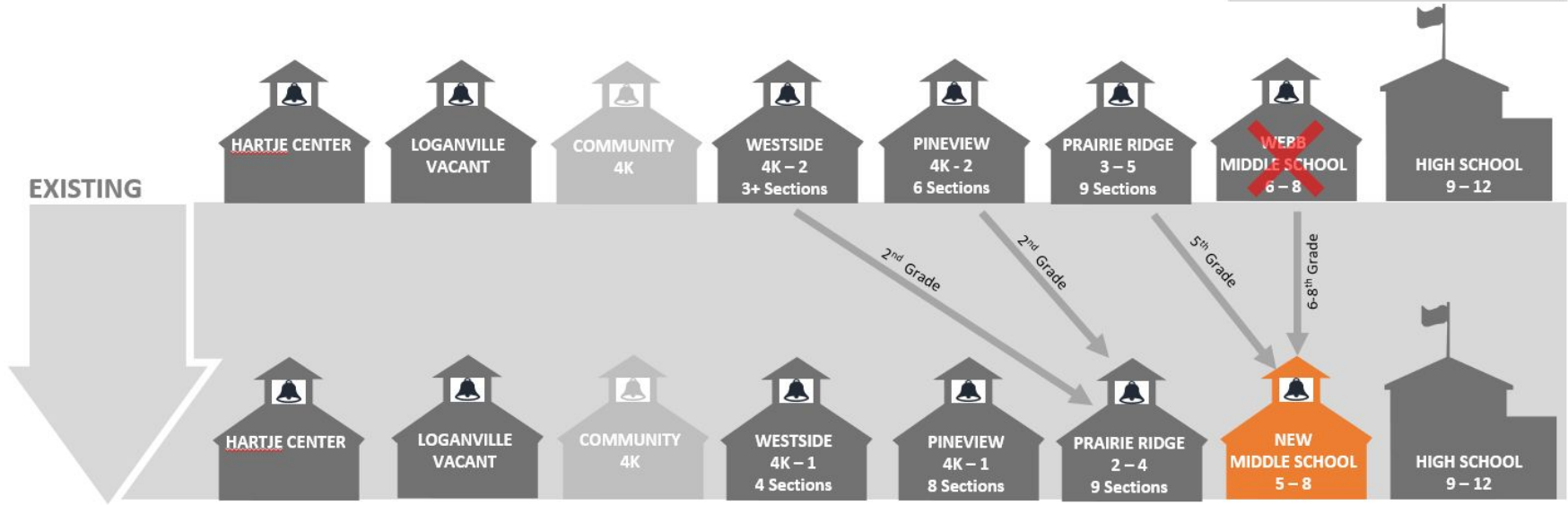

PROPOSED

- Relocation of 2nd grade allows building to become 4 sections
- Relocation of 2nd grade allows building to become 8 sections
- PRI would serve grades 2-4
 - Building will need an addition in the future to serve predicted enrollment
- Construct new middle school on district owned property
- Size building to accept the entire 5th grade from Prairie Ridge

OPTION B: NEW 5-8 MIDDLE SCHOOL



SD of Reedsburg : Long-Term Facilities Planning

Option B:

Replace Webb with New 5-8 Middle School

Significantly Under Capacity	(-151 & more)
Under Capacity	(-26 to -150)
Within Capacity	(+/- 25)
Over Capacity	(+26)

																Indicates Year Data Taken Directly From MD Roffers						
Enrollment Projections Based on MD Roffers 03.21.2022 Study - Open Enrollment In																						
Grade Configuration & Current Capacity	2021-2022	2022-2023	2023-2024	2024-2025	2025-2026	2026-2027	2027-2028	2028-2029	2029-2030	2030-2031	2031-2032	2032-2033	2033-2034	2034-2035	2035-2036							
EC																						
All 4K	144	155	166	166	166	166	167	168	169	170	170	170	170	170	170							
Half 4K	72	78	83	83	83	83	83.5	84	85	85	85	85	85	85	85							
Half of Half 4K	36	39	42	42	42	42	42	42	42	43	43	43	43	43	43	2+ sections 2036						
K-2 Enrollment	505	515	526	531	535	541	547	553	560	565	568	571	574	577	580							
Per Grade K-2	168	172	175	177	178	180	182	184	187	188	189	190	191	192	193	9+ sections 2036						
3-5 Enrollment	511	514	517	527	536	542	548	554	560	566	569	573	576	579	582							
Per Grade 3-5	170	171	172	176	179	181	183	185	187	189	190	191	192	193	194	8+ sections 2036						
6-8 Enrollment	583	574	566	556	547	551	556	560	565	569	575	582	589	595	602							
Per Grade 6-8	194	191	189	185	182	184	185	187	188	190	192	194	196	198	201	8 classrooms 2036						
9-12 Enrollment	896	910	924	919	914	900	885	870	855	841	844	847	851	854	857							
Per Grade 9-12	224	228	231	230	229	225	221	218	214	210	211	212	213	214	214	8+ classrooms 2036						
							(4K-1)															
(4K-2) Enrollment/Projection	541	554	568	573	577	583	406	411	416	419	421	423	425	427	429	Enrollment/Projection						
553 Capacity (90%)	553	553	553	553	553	553	553	553	553	553	553	553	553	553	553	Capacity						
							(2-4)															
(3-5) Enrollment/Projection	511	514	517	527	536	542	548	554	560	566	569	573	576	579	582	Enrollment/Projection						
559 Capacity (90%)	559	559	559	559	559	559	559	559	559	559	559	559	559	559	559	Capacity						
							(5-8)									(9 section)						
(6-8) Enrollment/Projection	583	574	566	556	547	551	738	744	752	757	764	772	780	787	795	Enrollment/Projection						
589 Capacity (75%)	589	589	589	589	589	589	850	850	850	850	850	850	850	850	850	Capacity						
							(9-12)															
(9-12) Enrollment/Projection	896	910	924	919	914	900	885	870	855	841	844	847	851	854	857	Enrollment/Projection						
1112 Capacity (80%)	1112	1112	1112	1112	1112	1112	1112	1112	1112	1112	1112	1112	1112	1112	1112	Capacity						

Nov 2024 Referendum: New 5-8 MS on District Owned Property for 850 Students

Occupy new 5-8 MS

Nov 2034 Referendum: Addition to Prairie Ridge Intermediate



**QUESTIONS?
COMMENTS?
FEEDBACK?**



10-Minute Break Prior to Activity



School Board “Destination” Brainstorming Activity

Let's Explore our Road Trip Ideas!



LONG-TERM "DESTINATION"

 UPDATE SYSTEMS	 NEW BUILDING
 BUILDING ADDITION	 MOVEMENT OF STUDENTS

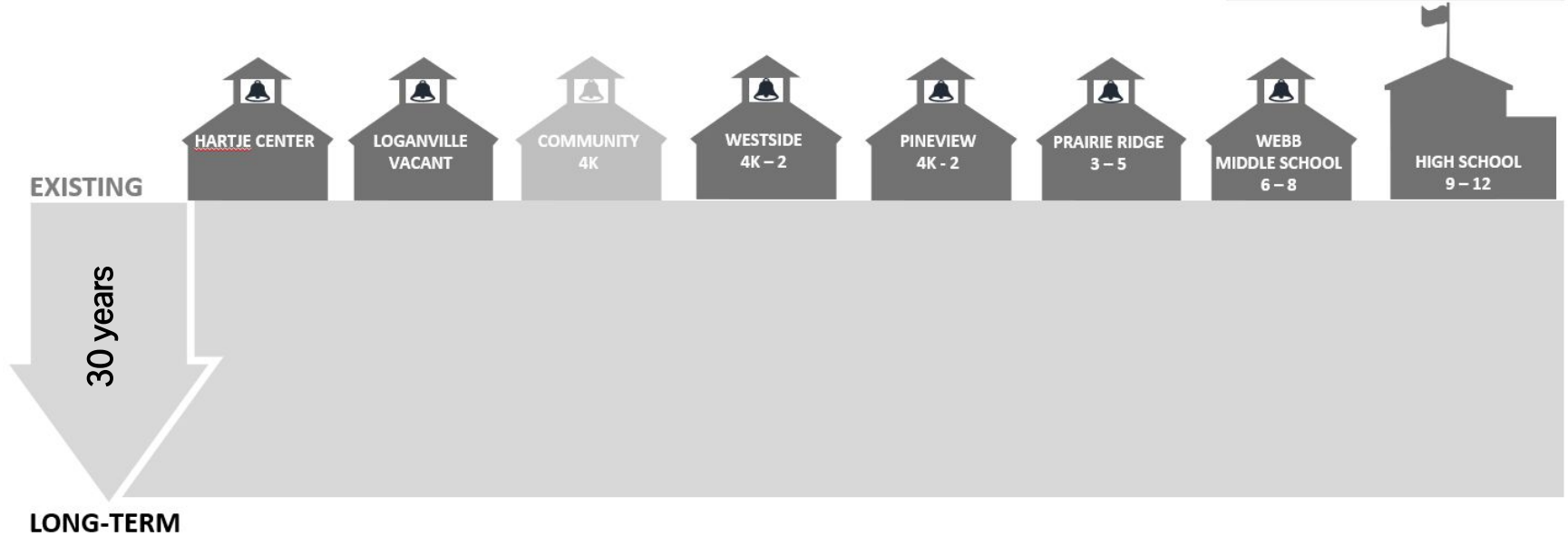

PRELIMINARY FACILITIES PLANNING TIMELINE



Long-Term Facilities Planning With 2024 General Election Target Referendum Date

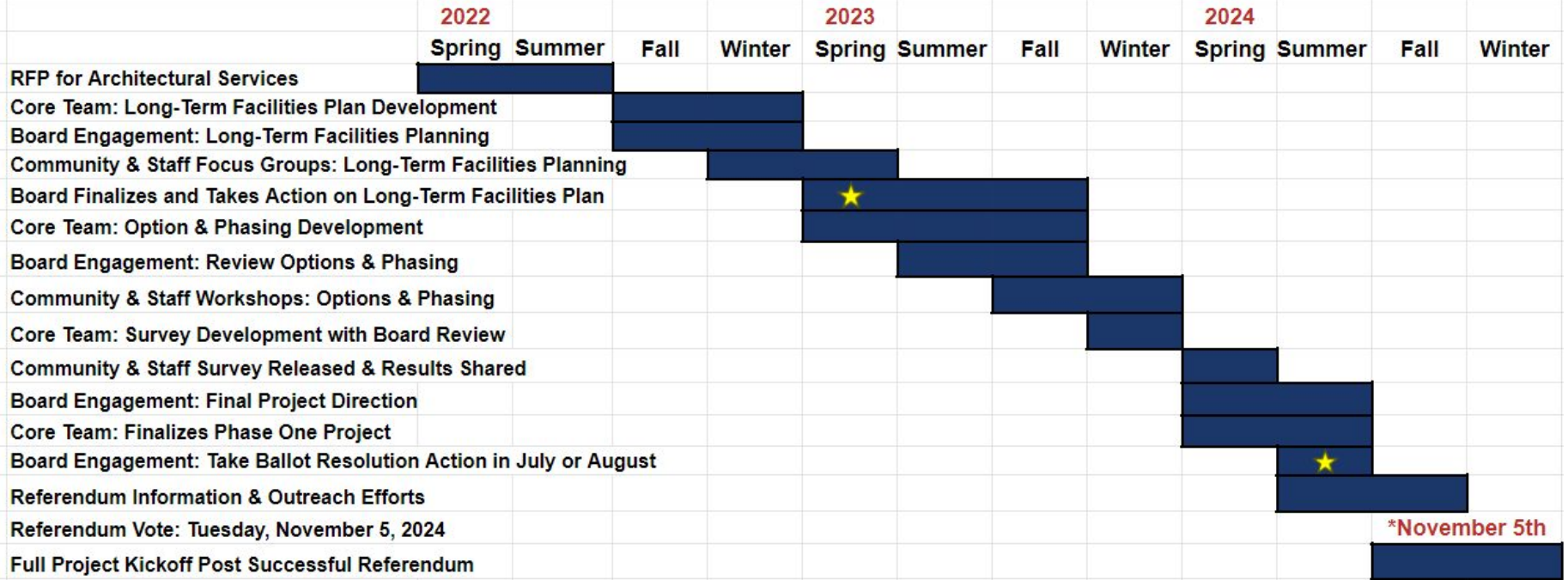

*November 5th



Next Steps on this “Road Trip” : January - June 2023



Long-Term Facilities Planning Schedule: Closer Look at January - June 2023 Road Trip

January 2023	February & March 2023	April & May 2023	June 2023
<p>Board Workshop (mid Jan.)</p> <ul style="list-style-type: none"> Share analyses (graphics & spreadsheet) of the “destination” ideas brainstorm activity from 12/14 workshop Connect teaching & learning initiative to long-term facilities planning <ul style="list-style-type: none"> Career Pathways Collaborative Practices Future of Loganville Share Modern Learning Environments presentation and recent project examples from across the state & country Share Focus Group strategy, structure, logistics, promo plan, gather input on questions <p>“Possible “bonus” social gathering at EUA’s office in Milwaukee during State Education Convention</p>	<p>Board Workshop (early Feb.)</p> <ul style="list-style-type: none"> Kraemer presents an overview of the current construction market, along with an updated FCA cost summary, including replacement of Webb. Connection to 10-Year Capital Plan, establishing Fund 46 before the end of June 2023. Discuss financial perspective associated with potential future costs Review upcoming Focus Group Informational Meeting content, details, promotion <p>Community & Staff Focus Groups (Round 1 - Large Group Sessions)</p> <ul style="list-style-type: none"> Present the Needs & Long-Term Facilities Planning Journey in Large Group Info Session Approach; must include engaging activities Host at Webb MS Cafeteria, Open Call to Community plus invitations Share current state of facilities with high level FCA cost summary Share replacement costs and site factors for Webb MS Share connection between teaching & learning and modern learning environments Share approach and explain what long-term facilities planning and how grade level configurations impact potential solutions <ul style="list-style-type: none"> Identify key topics for discussion & dialogue Brief Survey/Google Form to help inform Round 2 discussion <p>Community & Staff Focus Groups (Round 2 - Small Group Sessions)</p> <ul style="list-style-type: none"> Mid-March 2023 (prior to spring break) - Offer Multiple Small Group Sessions - Mostly Listening! <ul style="list-style-type: none"> Brief recap of info shared in Round 1 Share survey feedback, ask follow questions Discuss grade level configurations, Webb, modern learning environments, other 	<p>Board Workshop (6) - One Each Month if Needed</p> <ul style="list-style-type: none"> Review & discuss a summary of focus group data & feedback <ul style="list-style-type: none"> What did we learn from the community & staff and how does this guide facilities planning? Update on Loganville study Update on Career Pathways study Discuss next steps for shaping the long-term facilities plan - recommendation coming in June 2023 Receive guidance and feedback from the Board on: <ul style="list-style-type: none"> Components of the FCA/capital maintenance that would require referendum dollars to complete; Grade configuration. 	<p>Board Workshop</p> <ul style="list-style-type: none"> Preliminary 2023-2024 budget and financial information <ul style="list-style-type: none"> What portion of the capital main, needs can be handled in Fund 10 / Fund 46? Provide Strategic Plan Update - foundation for facilities work, other reports Provide recommended Long-Term Facilities Plan for Board <ul style="list-style-type: none"> High-level “destination” Approach to Webb MS Share example of options, phasing, costing to be explored in coming months Outline schedule for next six-months with a light break over the summer



LONG-TERM FACILITY PLANNING

ILLUSTRATIVE
PURPOSES
ONLY

EXAMPLE OF LONG-TERM “DESTINATION”

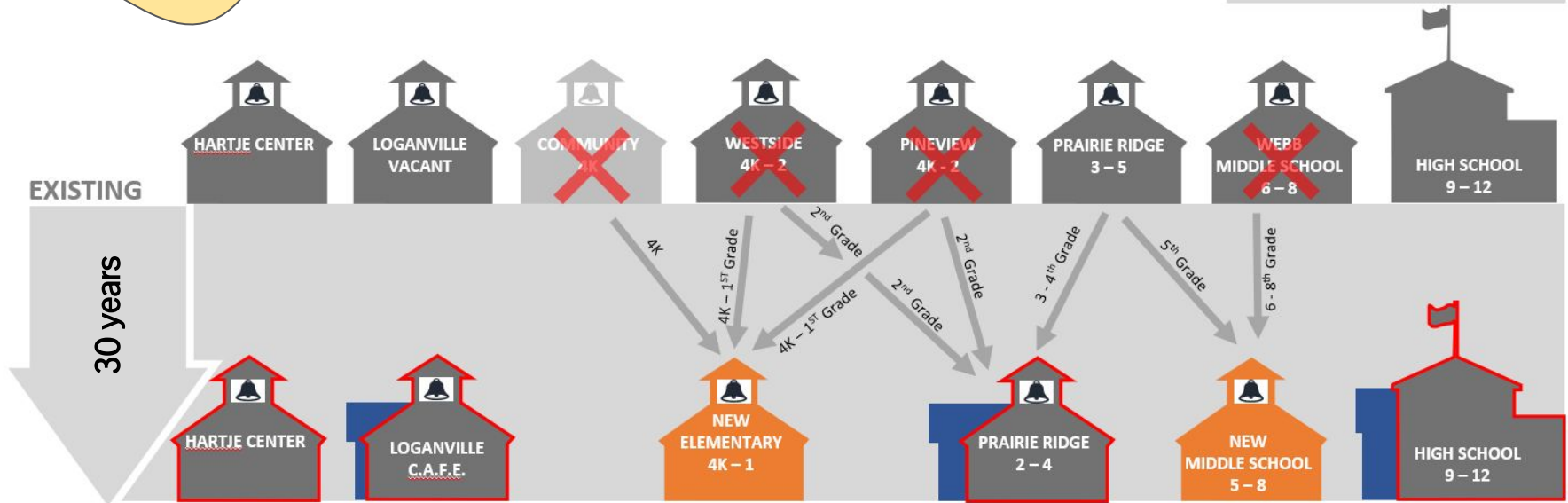

LONG-TERM

- Improve amenities for outdoor education center
- Update facility and provide possible additions for new use
- Construct new elementary school at Pineview site
- Building will need an addition in the future to serve predicted enrollment
- Construct new middle school on district owned property
- Would likely require addition for career pathway improvements



Success Criteria for Tonight's Workshop

- ✓ Understand updated building capacity and utilization information, as well as how the various “funnel factors” impact long-term facilities planning.
- ✓ Become familiar with long-term planning tools (spreadsheets, building diagrams) and how they will help us explore different “what if?” options
- ✓ Identify “destination/ big ideas” for future exploration and analysis
- ✓ Leave with common messaging and understanding about the next steps in the work, in particular from January - June 2023.



Key Takeaways from December 14 Workshop

- The Board is engaged and working together well, and members have been open to different perspectives as the planning process has evolved.
- Long-term facilities planning IS strategic planning. The Board is developing a plan to meet our facility needs for the next 30 years.
- Analytical processes will assist the Board in evaluating potential solutions.
- Just replacing Webb Middle School alone won't solve our long-term facility needs. The scope of this process encompasses the entire district's needs.
- Beyond building capacities, program needs, instructional delivery models, and career pathways for students will drive the facility plan decision-making.
- The School Board is working together in a collaborative and thoughtful manner. Many long-term options are being explored, and there are no preconceived solutions.





SCHOOL DISTRICT OF
REEDSBURG

Figure 12: Projected RSD Resident plus Open-Enrollment-In to Building Capacity, Alternate School Configuration

Facility ¹	September 2021 ²		Projected Resident Enrollment Plus OEI ³				Projected <u>Total</u> Enrollment Change	Building Capacity ⁴
	Total Students in Seats	RSD Resident Students	2023-24	2025-26	2030-31	2035-36		
4K at Community Partner Sites ⁵	72	64	83	83	85	85	+13	N/A
Pineview Elementary (4K-2) ⁶	329	307	357	373	393	402	+73	293
Westside Elementary (4K-2) ⁶	195	187	233	245	257	263	+68	189
Ironton-La Valle Elementary (K-2)	23	21	0	0	0	0	-23	N/A
Loganville Elementary (K-2/3)	30	28	0	0	0	0	-30	N/A
4K-2 RSD BUILDING TOTALS	577	543	590	618	650	665	+88	482
Prairie Ridge Intermediate (3-5)	511	482	517	536	566	582	+71	476
Webb Middle (6-8)	583	555	566	547	569	602	+19	612
Reedsburg Area High (9-12)	896	836	924	914	841	857	-39	992
4K-12 GRAND TOTALS	2,639	2,480	2,680	2,698	2,711	2,791	+152	2,562

